

CASH 9k INSTRUCTION MANUAL

WARNING

Use proper safety equipment before handling. Ensure firearm is not loaded before installing or removing the suppressor. Only operate the suppressor system with a serviceable firearm and ammunition of the correct caliber. Do not disassemble the suppressor system beyond required level, as shown in this manual, for standard maintenance.

The suppressor system can reach extremely hot temperatures. Use caution before handling after use. Avoid contact with skin or clothing when hot. Improper installation or use may result in serious injury or death.

Discharging firearms in poorly ventilated areas, cleaning firearms or handling ammunition may result in exposure to lead and other substances, which can cause birth defects, reproductive harm and other serious physical injury. Ensure adequate ventilation at all times. Wash hands thoroughly after exposure.

LEGAL WARNINGS

Suppressors (often referred to as silencers, cans, or mufflers) are controlled under both the National Firearms Act (NFA) (26 U.S.C. §5849 et seq.) and the Gun Control Act (18 U.S.C. §921 et seq.).

Storing an unlocked sound suppressor at home with a person who is not registered to possess the device may be construed as “constructive possession” by the ATF, which may be punishable by law.

This product is manufactured in the USA by HUXWRX Safety Co for sale within the USA only. Export of this commodity is strictly prohibited without a valid export authorization from the U.S. Department of State - DDTC and/or the U.S. Department of Commerce - BIS as prescribed in ITAR 22 CFR Part 120-130 and/or EAR 15 CFR Part 774.

It is your responsibility to check your local state and federal laws for ownership, hunting, transferring and transporting laws regarding silencers.

HOUSING

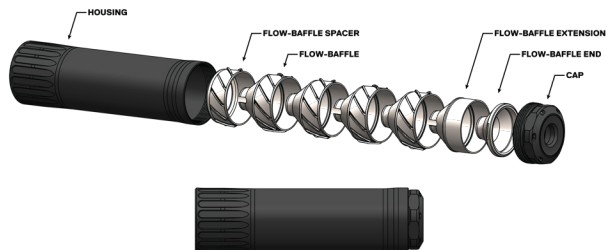

- Note that Flow-Baffles™ will protrude from the end of the housing.
- A 1/2” or 5/8” dowel can be used to push out the Flow-Baffles.
- A flat head screwdriver can be used to separate the Flow-Baffles.

ACCESSORIES

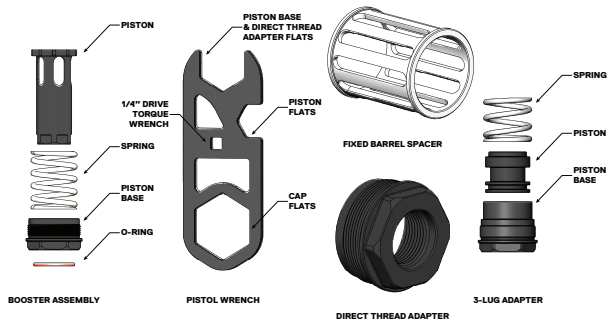

For more information or to browse HUXWRX' accessories, visit: huxwrx.com/shop-all/accessories

ASSEMBLY AND INSTALLATION

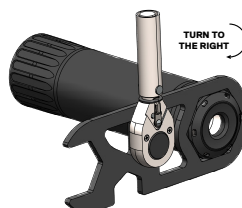

TORQUE CAP TO 100 LBF-IN (115 KGF-CM)

The CASH 9k comes preassembled with a 1/2-28 Direct Thread Adapter. Ensure the Direct Thread Adapter is firmly tightened or torqued before firing.

NOTE: An adjustable wrench on the piston flats can be used as an opposing force to remove the cap and piston base.

ACCESSORY INSTALLATION

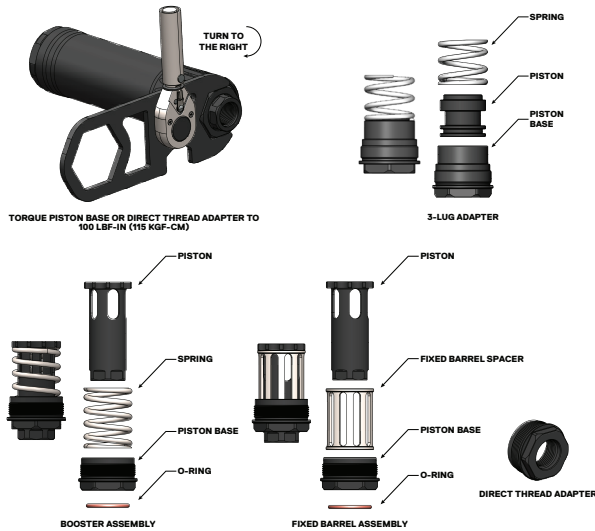

1. The Direct Thread Adapter comes preassembled in the CASH 9k. The Direct Thread, 3-lug Adapter, or Fixed Barrel Spacer are necessary for the suppressor to function correctly on weapon systems that have fixed barrels.
2. The Booster Assembly with Spring is necessary to function on weapon systems where the barrel reciprocates. Use high temperature grease on the Piston, Spring, and O-ring before each session of use.
3. Ensure all threads are clean before assembly.
4. To disassemble the Booster, 3-lug Adapter, and Fixed Barrel Assemblies from the housing, use the Pistol Wrench on the Piston Base flats along with an adjustable wrench on the Piston flats if necessary.
5. Tighten the Piston Base, 3-lug Base, or Direct Thread Adapter using the included Pistol Wrench, firmly by hand or using a ¼ drive torque wrench to 100 lbf-in (115 kgf-cm).

SUPPRESSOR INSTALLATION

WARNING: Ensure the firearm is unloaded. Remove the magazine and all ammunition from the workspace. Visually and physically check that the chamber is clear.



1. Thread the suppressor onto the barrel until it bottoms out, either on the crown or shoulder of the barrel depending on the thread.
2. Verify that the barrel and accessory thread patterns match.
3. Ensure all threads are clean before assembly.
4. For handguns, make sure that the booster assembly is installed, lock the slide open to allow more room for the Pistol Wrench with torque wrench attached.
5. Tighten the Direct Thread Adapter, or Piston to the barrel using the included Pistol Wrench, firmly by hand or using a 1/4 drive torque wrench to 125 lbf-in (144 kgf-cm)

SUPPRESSOR CLEANING AND MAINTENANCE

WARNING: Ensure the firearm is unloaded. Remove the magazine and all ammunition from the workspace. Visually and physically check that the chamber is clear. Wear proper safety equipment, not limited to safety glasses, chemical-resistant gloves.

Booster and Fixed Barrel Assembly

- Recommended maintenance cycle for the Booster Assembly is to, before each session, apply a light coat of high temperature grease on the bearing surfaces of the Piston, Spring, and O-ring.
- Inspect the O-ring on the inside of the Piston Base for damage before each session. If damaged, remove and replace it with a O18 size Viton O-ring available through HUXWRX.
- To detach the suppressor from the host firearm (lock the slide back if a handgun) use the Pistol Wrench and torque wrench or adjustable wrench on the Piston wrench flats to remove the suppressor from the host firearm.
- To detach the Booster and Fixed Barrel Assemblies from the Housing, use the Pistol Wrench on the Piston Base flats along with an adjustable wrench on the Piston flats if necessary.

Housing and Flow-Baffles

- Recommended maintenance cycle for the suppressor Housings and Flow-Baffles is every 1000 rounds or less.
- Disassemble the assembly down to the individual components shown in the exploded assembly view.
- The Flow-Baffles, Spring, and Fixed Barrel Spacer are heat-treated stainless steel so can be cleaned with a steel bristle brush, wire wheel, ultrasonic cleaner, media tumbler, tool with elbow grease and CLP to remove fouling.
- The serialized housing is titanium coated with high temp Cerakote, and it contains a heat-treated stainless-steel Piston Base that is assembled at the factory with high temp thread locker. A steel bristle brush and tools can be used inside the Piston Base to remove fouling from the Piston interface. The Housing can be cleaned with CLP, nylon brushes and/or an ultrasonic cleaner. Ensure all threads are clean before reassembly.
- The Housing Module, Piston Base, Cap are hard coat anodized aluminum. The Housing Module is also high temp Cerakoted. Use nylon brushes and CLP to remove any fouling. Ensure all threads are clean before reassembly.
- The Pistons and Direct Thread Adapters are heat treated and nitride coated stainless steel. They can be cleaned with CLP and a brass or nylon brush and/or in an ultrasonic cleaner. Ensure all threads are clean before reassembly.

WARRANTY

There is a limited lifetime warranty against all manufacturing defects and damages caused by the normal use of this product. The manufacturer will repair or replace free of charge any suppressor manufactured by or, at the direction of, HUXWRX Safety CO. LLC.

The product is sold "as is" with no further implied contractual rights or warranties beyond those expressly stated herein.

Visit www.huxwrx.com for more warranty information.